

LH-65

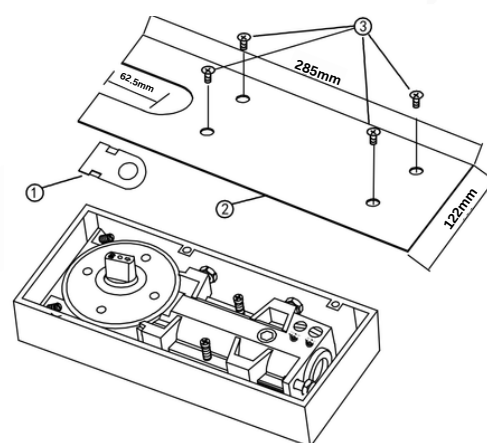
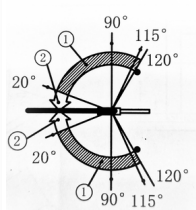
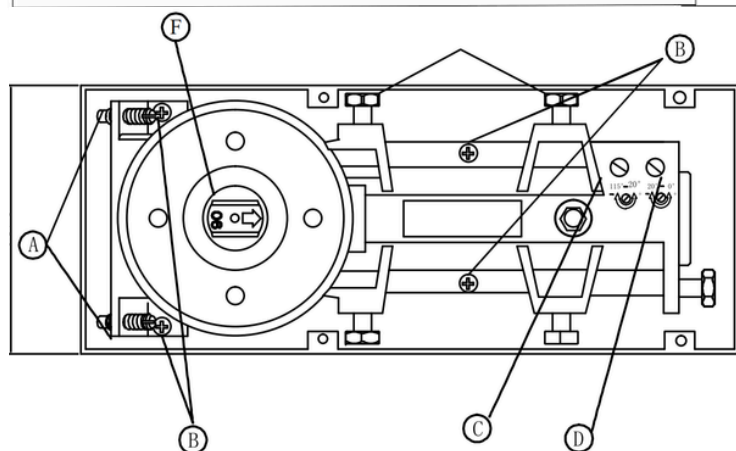
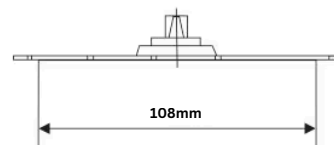
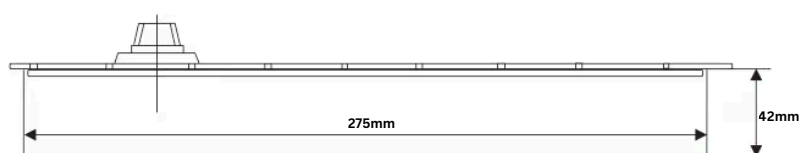

Product Description

- A-Fixing screw
- B-Height adjustment Screw
- C-Regulation valve 90° ~ 20°
- D-Regulation valve 20° ~ 0°
- E- Left and right adjustment Screw
- F- Pivot Centre

Adjustment In Cement Box

To adjust the position of floor spring cement box loosen fixing screw (A) Move floor spring to required position and use screw (B) for height adjustment.

Retighten screw (A) after adjustment.

Centre hung doors

For centre hung doors. floor spring should be in the centre of cement box.

Maximum door opening angle is 120° in each direction.

For doors opening up to 120° door stop MUST be fitted.

Ensure that top centre is properly aligned with floor spring

Adjustment Of Closing Speed.

Two regulating valves (C) and (D). (↗) decrease closing speed. (↘) increase closing speed.

Valve C: controlled closing range 90° - 20°

Valve D: controlled closing range 20° - 0°

Attachment Of Cover Plate

Press Insert piece (1) Into gap behind spindle and secure cover plate (2) to floor spring with fixing 3

- 1-Insert place
- 2-Cover plate



Silver Mirror



Silver Brush



Black Matt



Gold Mirror